

[OEFE-100]

## High Power Fiber End Cap

### Features:

- Allows much higher transmitted power
- AR coating at various wavelengths
- Matched to the most of fiber types and NA
- PM or non-PM
- Low beam distortion
- Custom design

### Applications:

- High power fiber lasers
- Fiber amplifiers
- Scientific research
- Sensors



Fiber end cap

### Product description:

A commonly point of damage in high power lasers is the fiber end at silica/air interface. Fiber end cap can remove this problem by reducing the power density. In addition, our end caps are coated by AR coating for the target wavelength to reduce the back reflection which is about 4% for non-coated silica surfaces. It's available in small (A type) and large (B types) sizes.

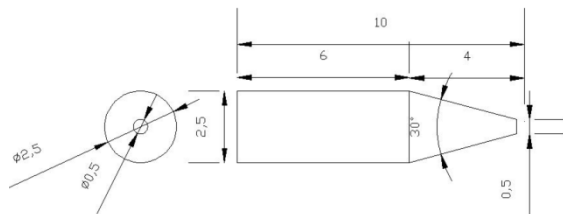

A-type end cap

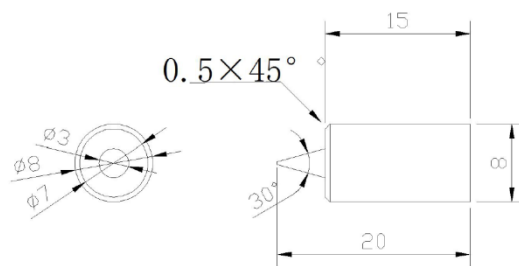

B-type end cap

### Ordering number:

OEFE-100-Type	Type
	A, B
	OEFE-100-A